

1	2	3	4	5	6	7	8	9	10

00	index AHC 3000 general
01	powersupply fan 230V
02	powersupply fan 400V
03	powersupply 24V DC
10	Overview OJ AHC 3000
11	OJ AHC 3000 Digital in
12	OJ AHC 3000 Analog in
13	OJ AHC 3000 Analog out
14	OJ AHC 3000 Digital out
	Overview PTH 6202-2, 6202, temp sensors, pressure sensors
20	Overview PTH 6202-2 and Ext module
21	overview temp. and pressure sensors with flow control HCP
22	overview temp. and pressure sensors with flow control HRWL
23	overview temp. and pressure sensors without flow control HCP
24	rotor controller
25	pressure controlled option
30	option discription
50	cabinet drawing & display connection 230V
51	cabinet drawing & display connection 400V
60	unit drawing HRW
61	unit drawing HCP

①	Get.	HMV
②	Datum	1-9-2020
③	-	-

Order	AHC 3000
Type	
Rev.	9
status	-

page discription	Index

Blz: **00**

identificatie van stroomgeleider
 kleurcodering:
 hoofdstromketen fase : zwart
 hoofdstromketen nul : blauw
 hoofdstromketen DC fase : rood
 hoofdstromketen DC nul : grijs

code voor kleurafkortingen
 volgens IEC 60757

wit : wh
 bruin : bn
 groe : gn
 geel : ye
 grijs : gy
 rose : pk
 blauw : bu
 rood : rd
 zwart : bk
 paars : vt
 oranje : og

Blad/ stramienverwijzing:

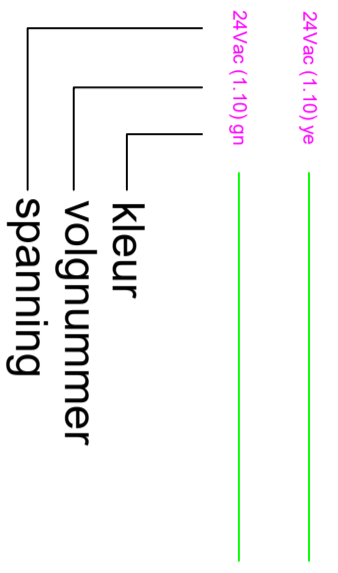

Blad/ stramienverwijzing:

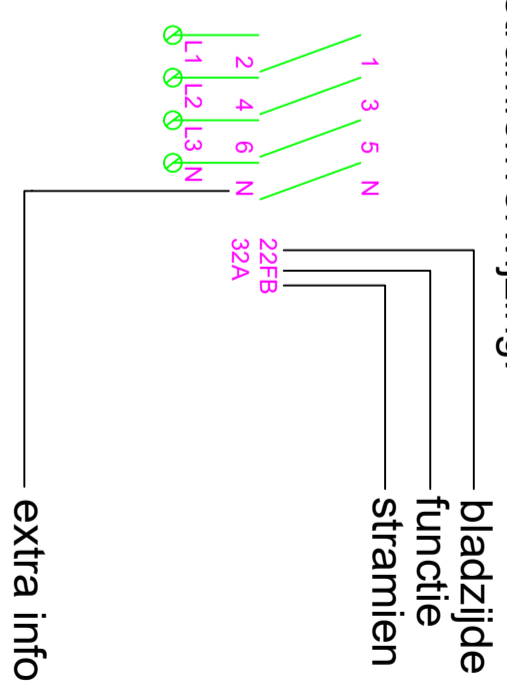

①	Get.	HMV
②	Datum	1-9-2020
③	-	-

Order Type	AHC 3000
Rev.	9
status	-

page discription	Index

Blz: 00

1	2	3	4	5	6	7	8	9	10
main power switch	exhaust fan	supply fan							

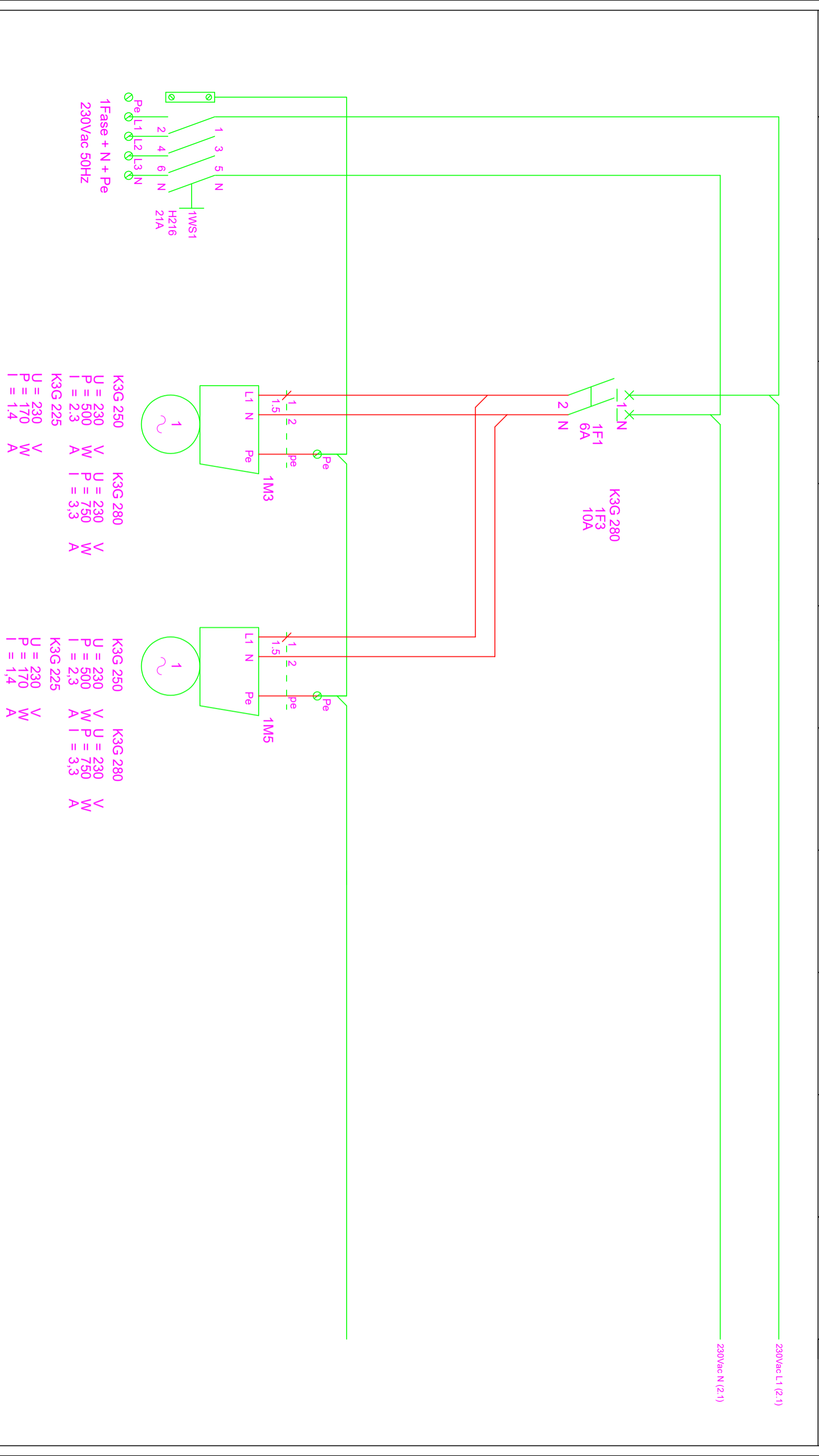

Get.	HMV	Order	AHC 3000	Page description	power supply 400V - 230V
Datum	3-9-2020	Type	9		
		Rev.			
		status			

Page : 01

1	2	3	4	5	6	7	8	9	10
main power switch	exhaust fan	supply fan							

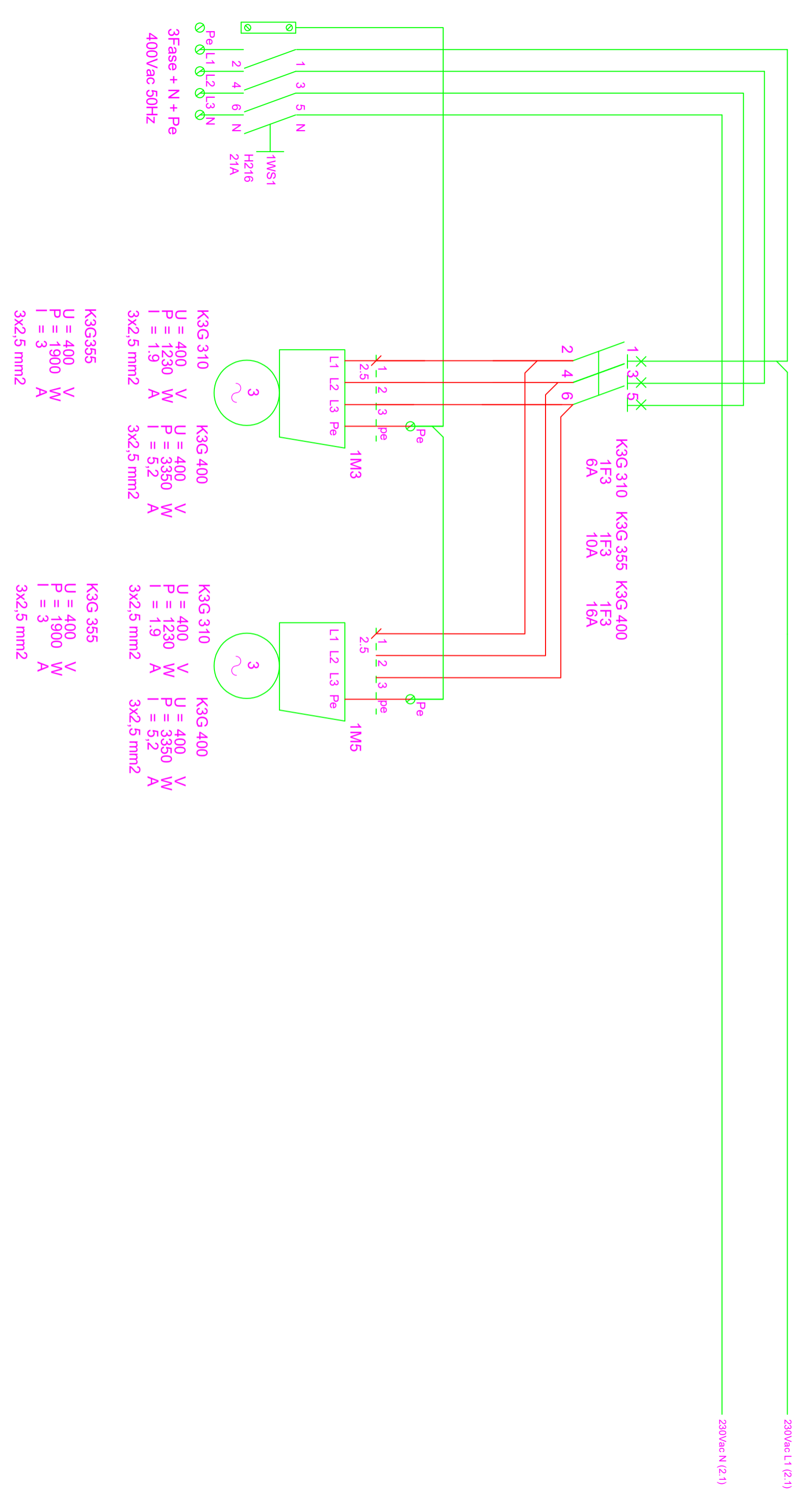

Get.	HMV	Order Type	AHC 3000	Page description	power supply 400V - 230V
Datum	3-09-2020	Rev.	9		
		status			

1	2	3	4	5	6	7	8	9	10
		powersupply Trafo	powersupply float pump		powersupply OJ Air2 AHC 3000		powersupply OJ Air2 DRHX 1120		
							rotor controller		

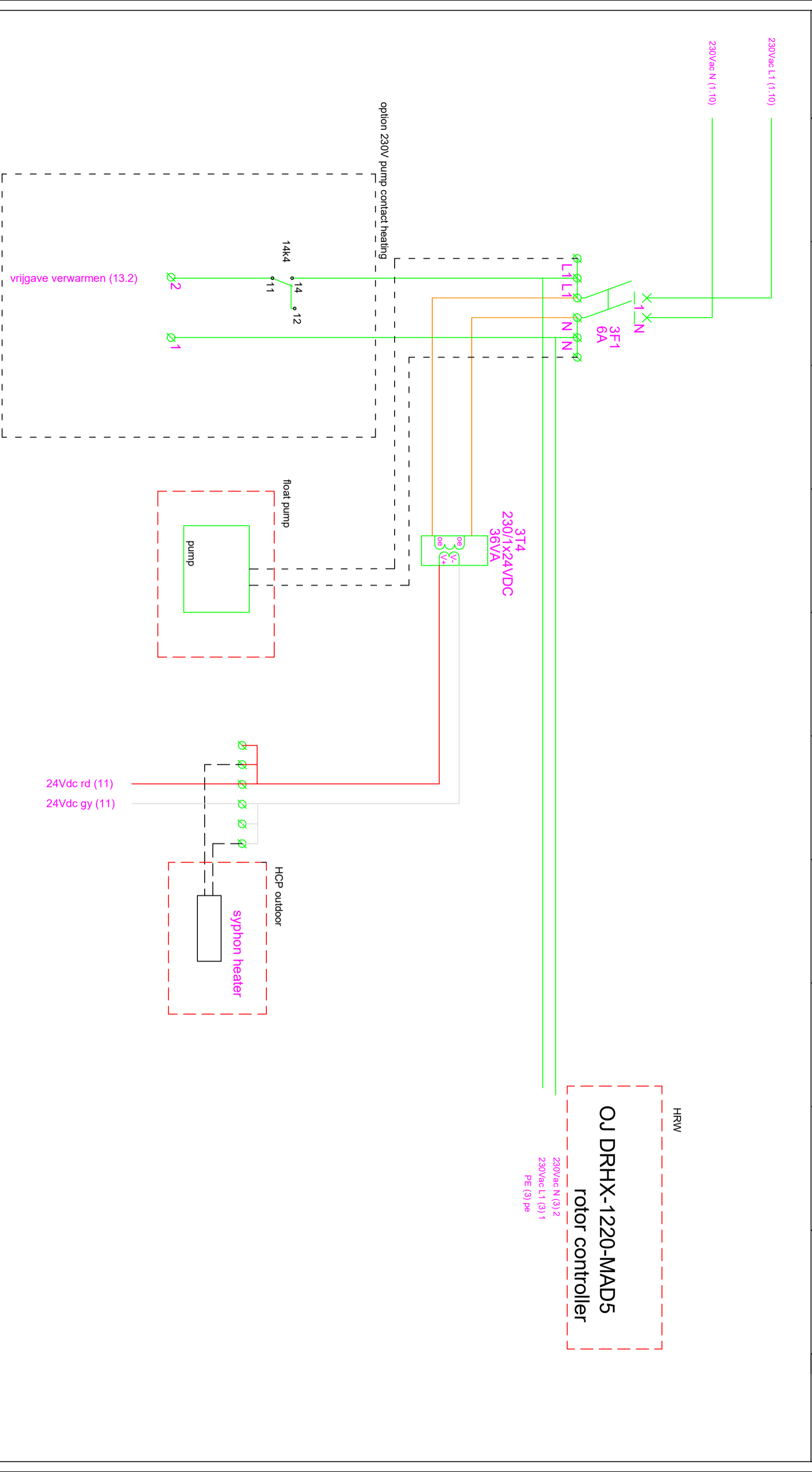

①	Get.	HMV	Order	AHC 3000	Page description	Page : 03
②	Datum	3-9-2020	Type		Powersupply 24VDC	
③			Rev.	9		
④			status	-		

1	2	3	4	5	6	7	8	9	10

OJ AIR AHC 3000T

Klem code	code	Klem code	code
1	COM Com	27	TI1
2	DO1 Heating or heating HP	28	GO
3	DO2 Cooling only heatpump	29	TI2
4	DO3 relay contact to com damper	30	GO
5/6	DO4 potential free relay A alarm	31	TI3
7/8	DO5 potential free relay B alarm	32	GO
9/10	DO6 potent. free relay supp start	33	TI4
11/12	DO7 potent. free relay exh start	34	GO
13	D11 alarm supply fan	35	TI5
14	D12 alarm exhaust fan	36	GO
15	D13 alarm filter	37	AO1
16	GO	38	GO
17	D14 smoke	39	AO2
18	D15 start/stop	40	GO
19	D16 high speed	41	AO3
20	GO	42	GO
21	D17 fire contact	43	AO4
22	GO	44	GO
23	A11 CO2	45	Dou6
24	A12 Room temp. supp duct press	46	Dou6
25	A13 RH % extract air duct press		
26	GO		

①	Get.	HMV
②	Datum	4-9-2020
③	-	-

Order	AHC 3000
Type	9
Rev.	-
status	-

page discription	overview OJ air AHC 3000T
------------------	---------------------------

Blz: **10**
A

1	Alarm supply fan	2	Alarm extract fan	3	Filter alarm	4	Smoke alarm	5	start/stop contact	6	high speed contact	7	Fire contact	8		9		10	power controller
---	------------------	---	-------------------	---	--------------	---	-------------	---	--------------------	---	--------------------	---	--------------	---	--	---	--	----	------------------

24Vdc + (3)
24Vdc - (3)

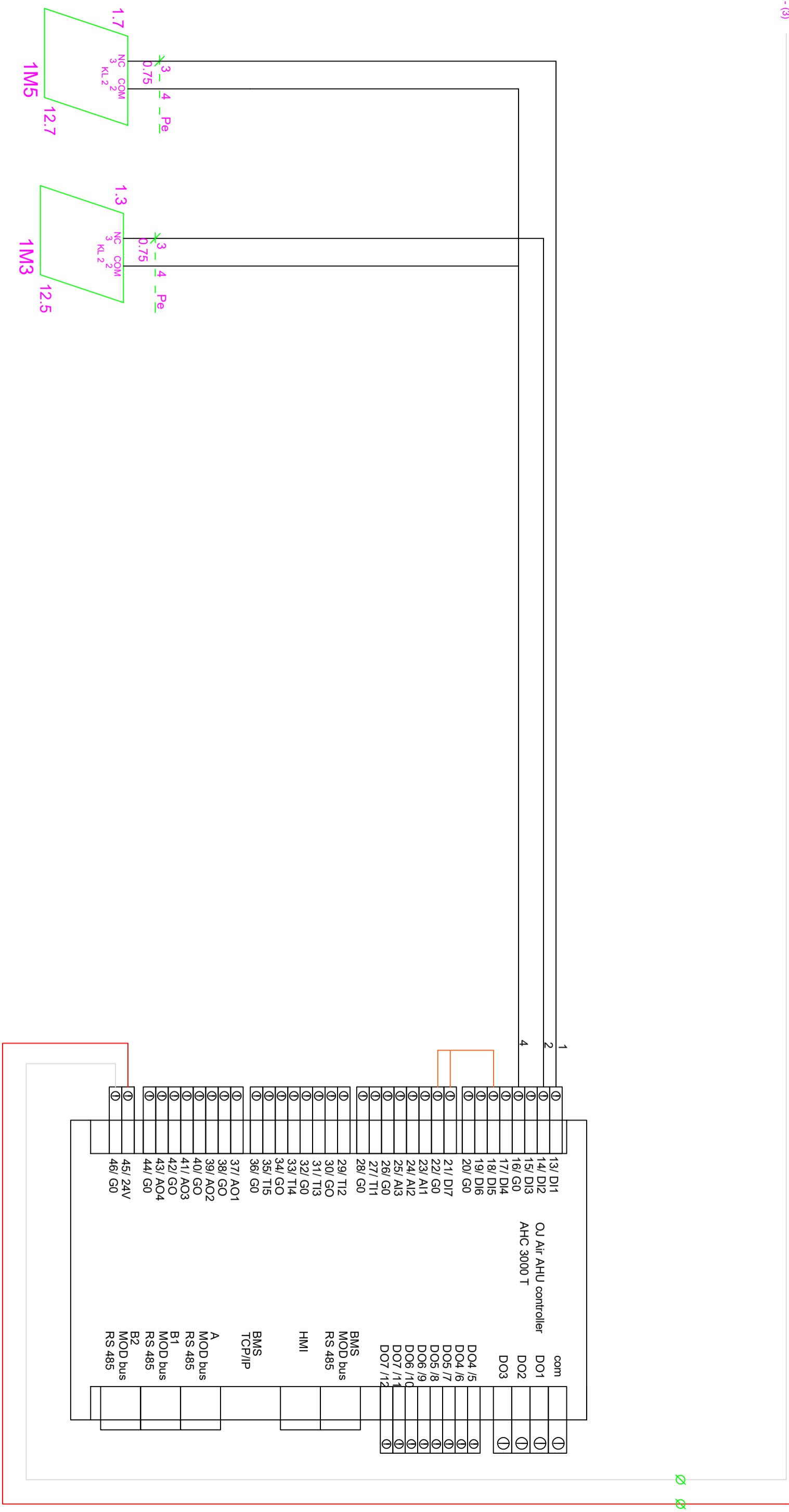

Get. Datum	HMV	Order Type	AHC 3000	Page description	Digital in	Blz:	11
-	4-9-2020	Rev.	9				
-	-	status	-				

1	2	3	4	5	6	7	8	9	10
CO2 sensor									

24Vdc + (3)
24Vdc - (3)

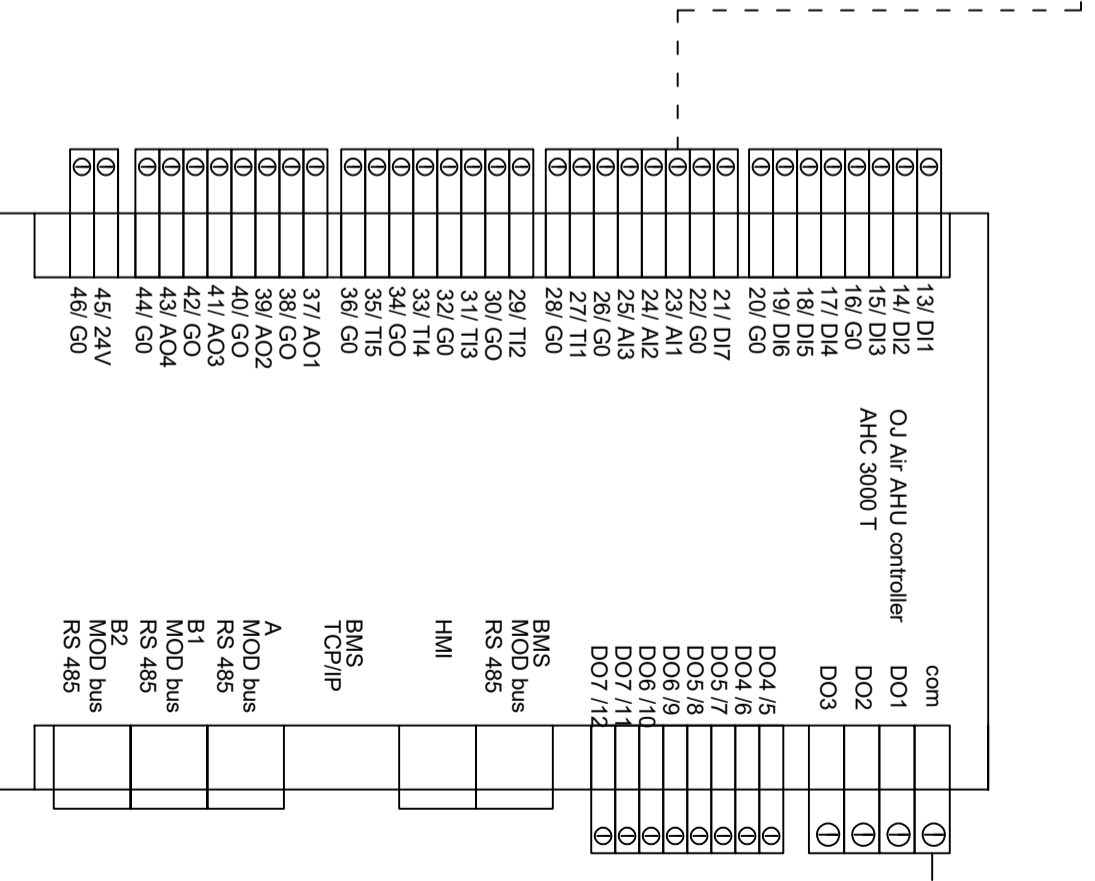
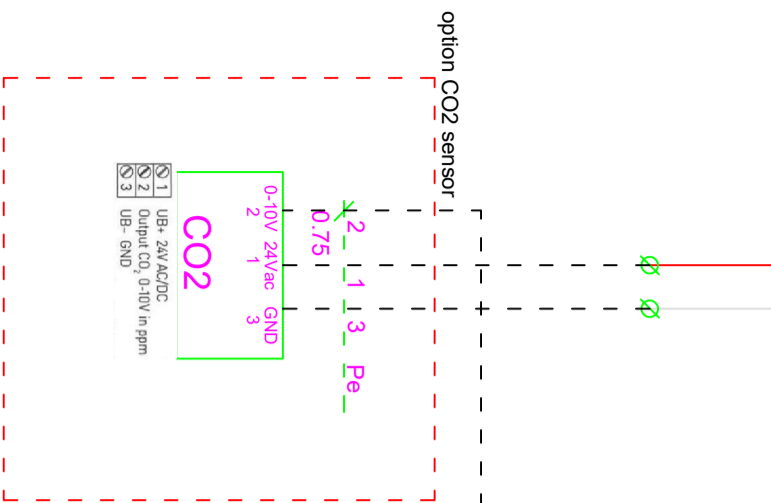

①	
②	
③	

Get.	HMV
Datum	4-9-2020
-	-

Order Type	AHC 3000
Rev.	9
status	-

Page description	Analog in

Blz: 12

1	2	3	4	5	6	7	8	9	10
AO 1	AO 2	AO 3	AO 4				AO1		
heating	cooling (HP)	afvoer	toevoer				Cooling		
cooling	heating (HP)	ventilator	ventilator				EXT modul		
							3, G /4, 10V		

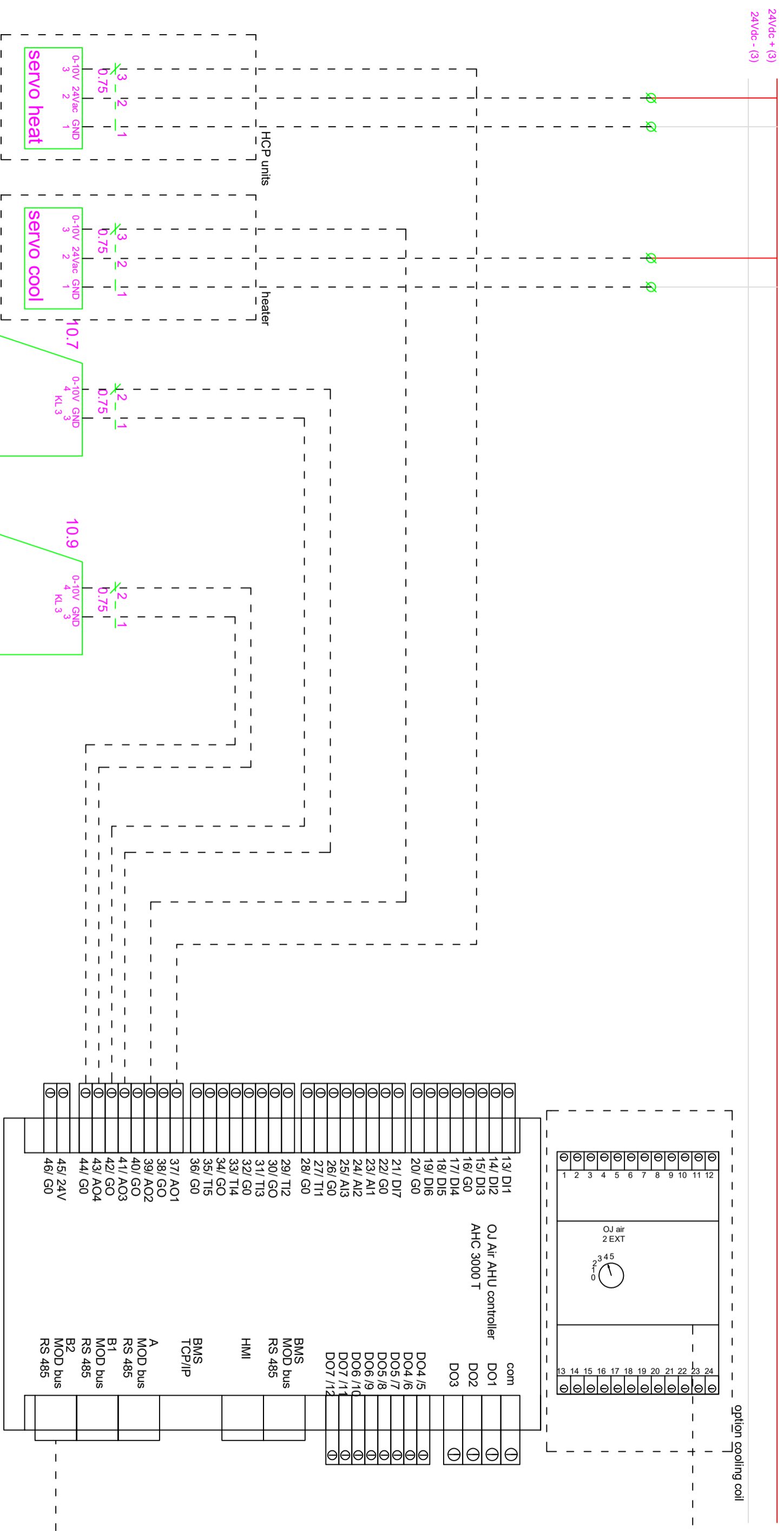

Get.	HMV	Order	AHC 3000	Page description	Blz: 13
Datum	4-9-2020	Type	9	Analog out	
		Rev.	-		
		status	-		

1	2	3	4	5	6	7	8	9	10	DO7
DO1				DO1	DO2	DO3	DO4	DO5	DO6	
heating (HP)				heating (HP)	cooling HP	Damper	A alarm	B alarm	supply fan	extract fan
EXT modul				relay	relay	contact	contact	contact	start	start
13/14				to com	to com	to com	contact	contact	contact	contact

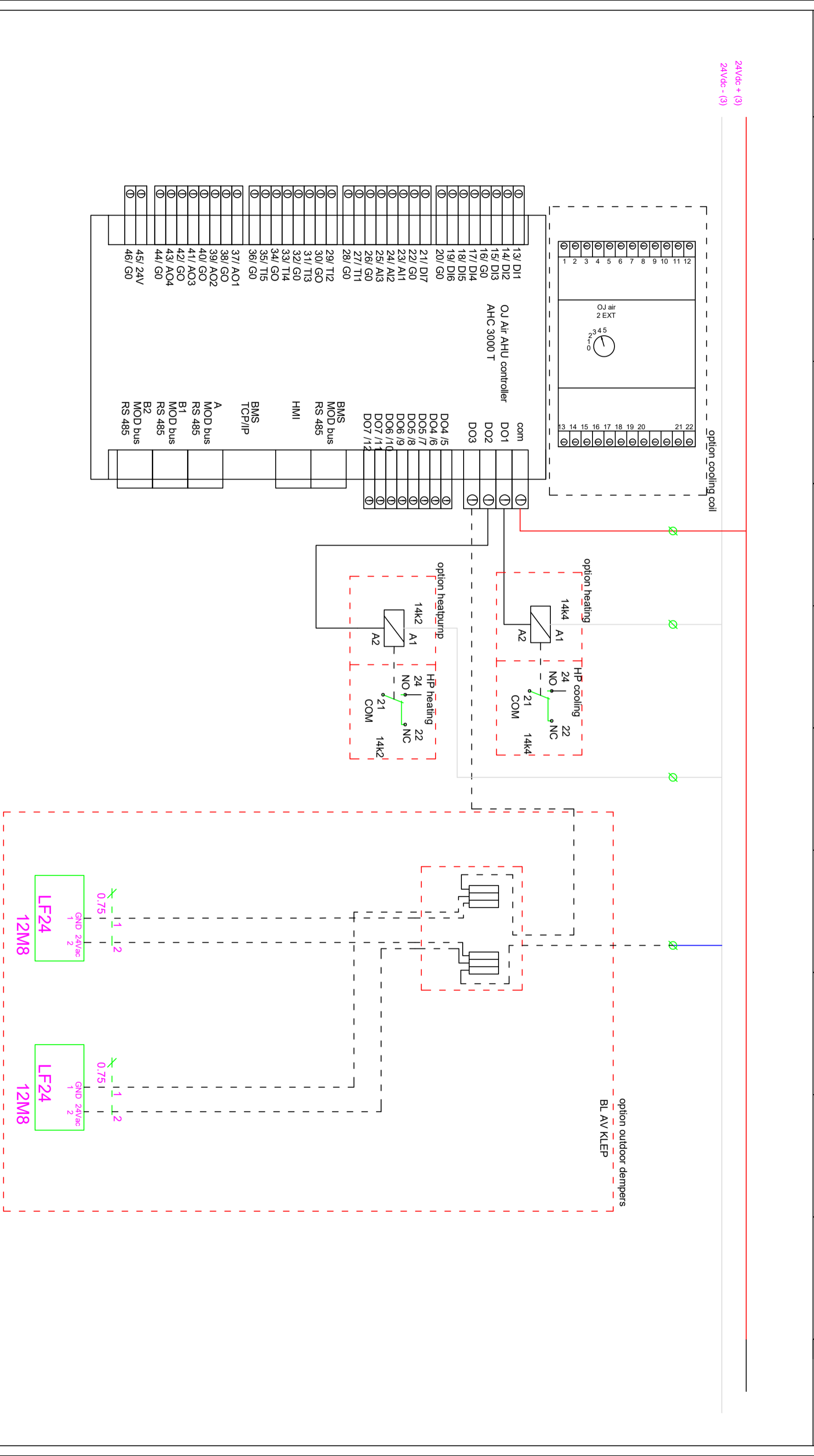

24Vdc + (3)
24Vdc - (3)

Get.	HMV	Order	Page description	Blz:	14
Datum	4-9-2020	Type	Digital out		
		Rev.			
		status			

	1	2	3	4	5	6	7	8	9	10

HCP

HRW/HCP Iying

PTH 6202-2 SW 4

Klem	code	code
1	T1	outdoor air temp
2	GND	GND
3	T2	extract air temp
4	GND	GND

PTH 6202-2 SW 1

Klem	code	code
1	T1	outdoor air temp
2	GND	GND
3	T2	exhaust air temp
4	GND	GND

PTH 6202-2 SW 5

Klem	code	code
1	T1	supply air temp
2	GND	GND
3	T2	exhaust air temp
4	GND	GND

PTH 6202-2 SW 2

Klem	code	code
1	T1	extract air temp
2	GND	GND
3	T2	supply air temp
4	GND	GND

option cooling coil

EXT SW 4

Klem	code	code	code
21	T2	temp supply	
22	GND	-	
13	DOU 1	cooling start	
14	DOU 1	not in use	
3	GND	-	
4	AOU 1	0-10V steering signal cooling	

		Get.	HMV
①		Datum	4-9-2020
②			
③			

Order	AHC 3000
Type	
Rev.	9
status	-

Page discription	
overzicht PTH 6202-2 and extension	

Blz:	20
------	----

1	TI1 sensor	2	TI2 sensor	3	TI3 sensor	4	TI4 sensor	5	TI5 sensor	6	7	8	HTH 6202 sensor	9	10
	supply	extract	outdoor	exhaust	frost protect								humidity		
													ventilation		

HCP

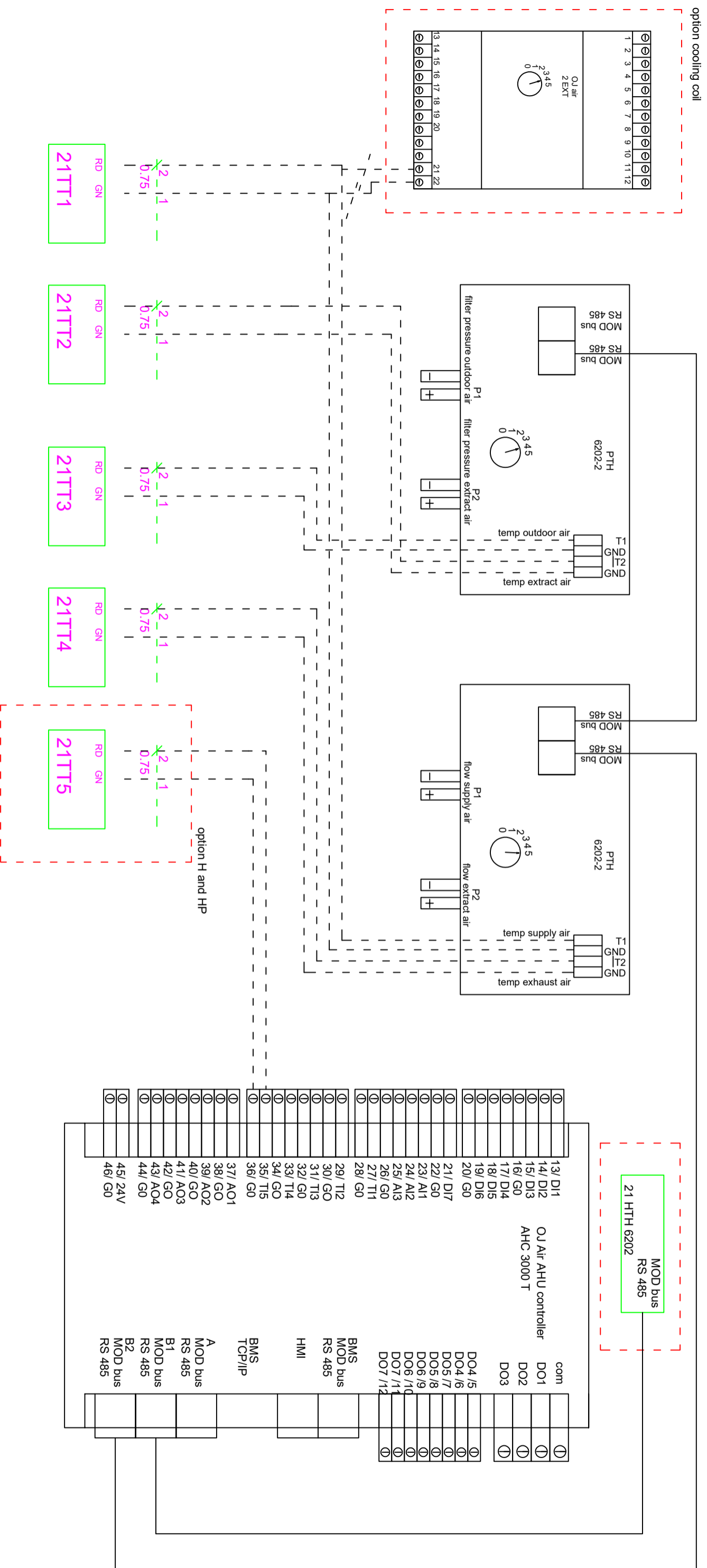

Get.	HMV	Order Type	HRW E general	Page description	temperature and pressure connections with flow control	Blz:	21
Datum	4-9-2020	Rev.	9				
		status	-				

1	TI1 sensor supply	2	TI2 sensor extract	3	TI3 sensor outdoor	4	TI4 sensor exhaust	5	TI5 sensor frost protect	6	7	8	HTH 6202 sensor humidity ventilation	9	10
---	-------------------------	---	--------------------------	---	--------------------------	---	--------------------------	---	--------------------------------	---	---	---	---	---	----

HRW/HCP Iying

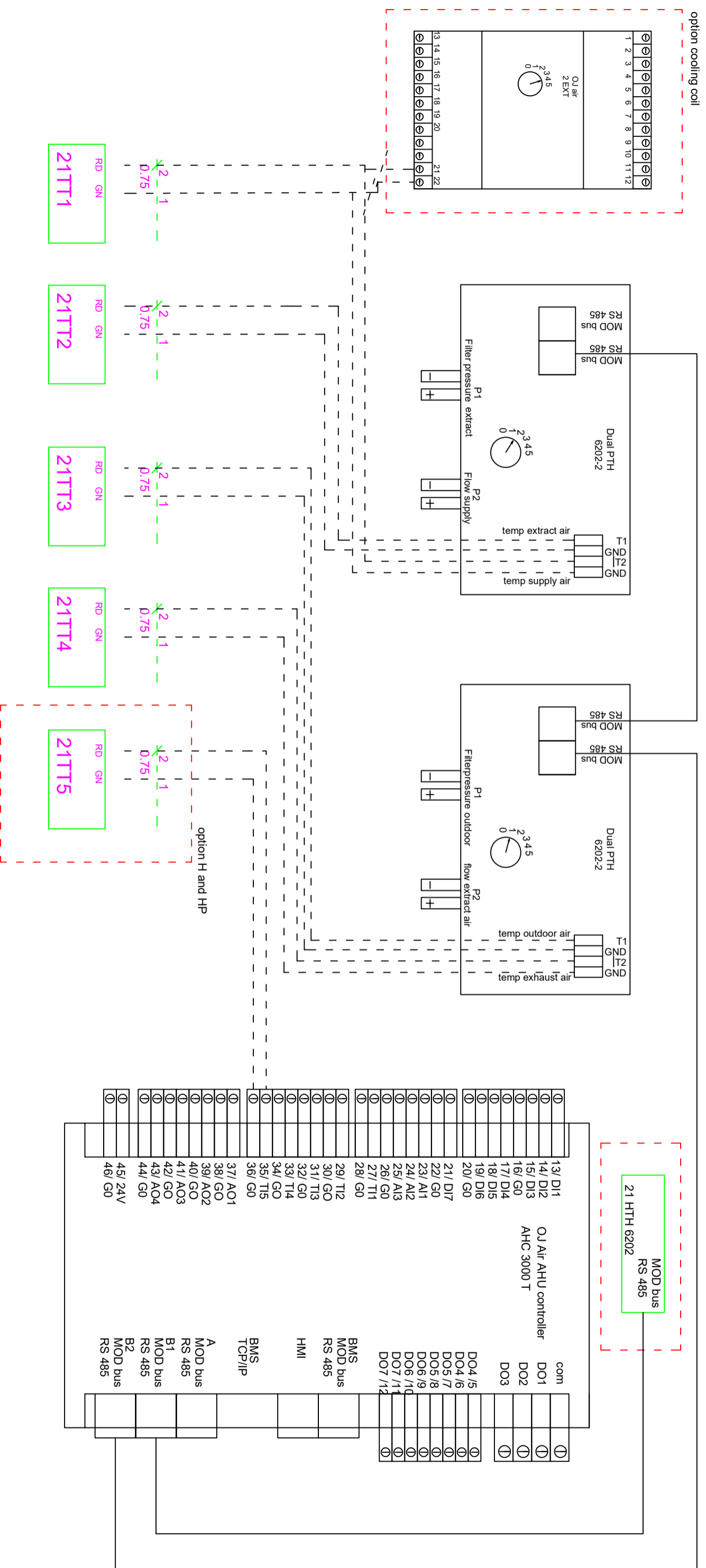

Get.	HMV	Order Type	HRW E general	Page description	temperature and pressure connections with flow control	Blz:	22
Datum	4-9-2020	Rev.	9				
		status	-				

1	TI1 sensor supply	2	TI2 sensor extract	3	TI3 sensor outdoor	4	TI4 sensor exhaust	5	TI5 sensor frost protect	6	7	8	HTH 6202 sensor humidity ventilation	9	10
---	-------------------------	---	--------------------------	---	--------------------------	---	--------------------------	---	--------------------------------	---	---	---	---	---	----

HCP 600/800

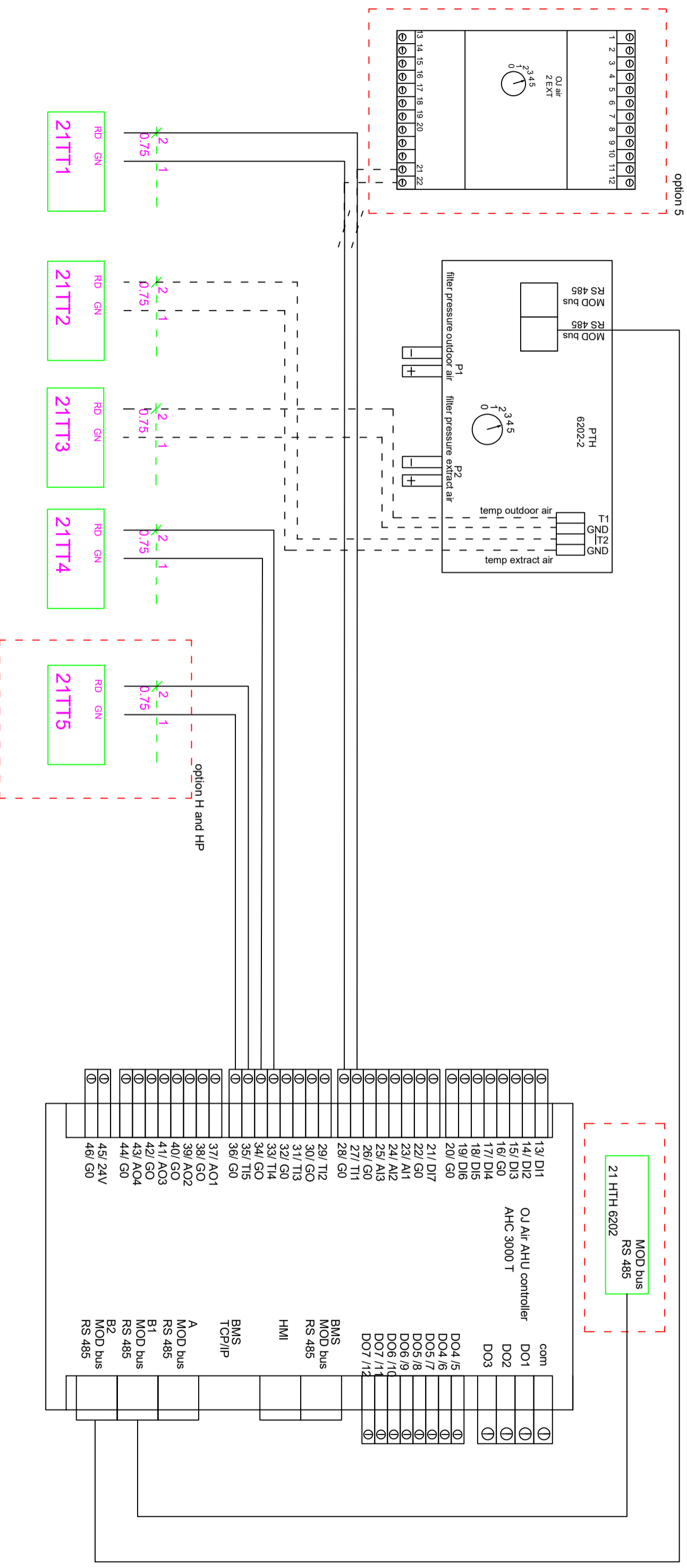

①	Get.	HMV	Order Type	AHC 3000	temperature and pressure connections without flow control	Blz: 23
②	Datum	4-9-2020	Rev.	9		
③			status	-		

1	2	3	4	5	6	7	8	9	10
							powersupply OJ Air2		
							DRHX 1120		
							rotor controller		

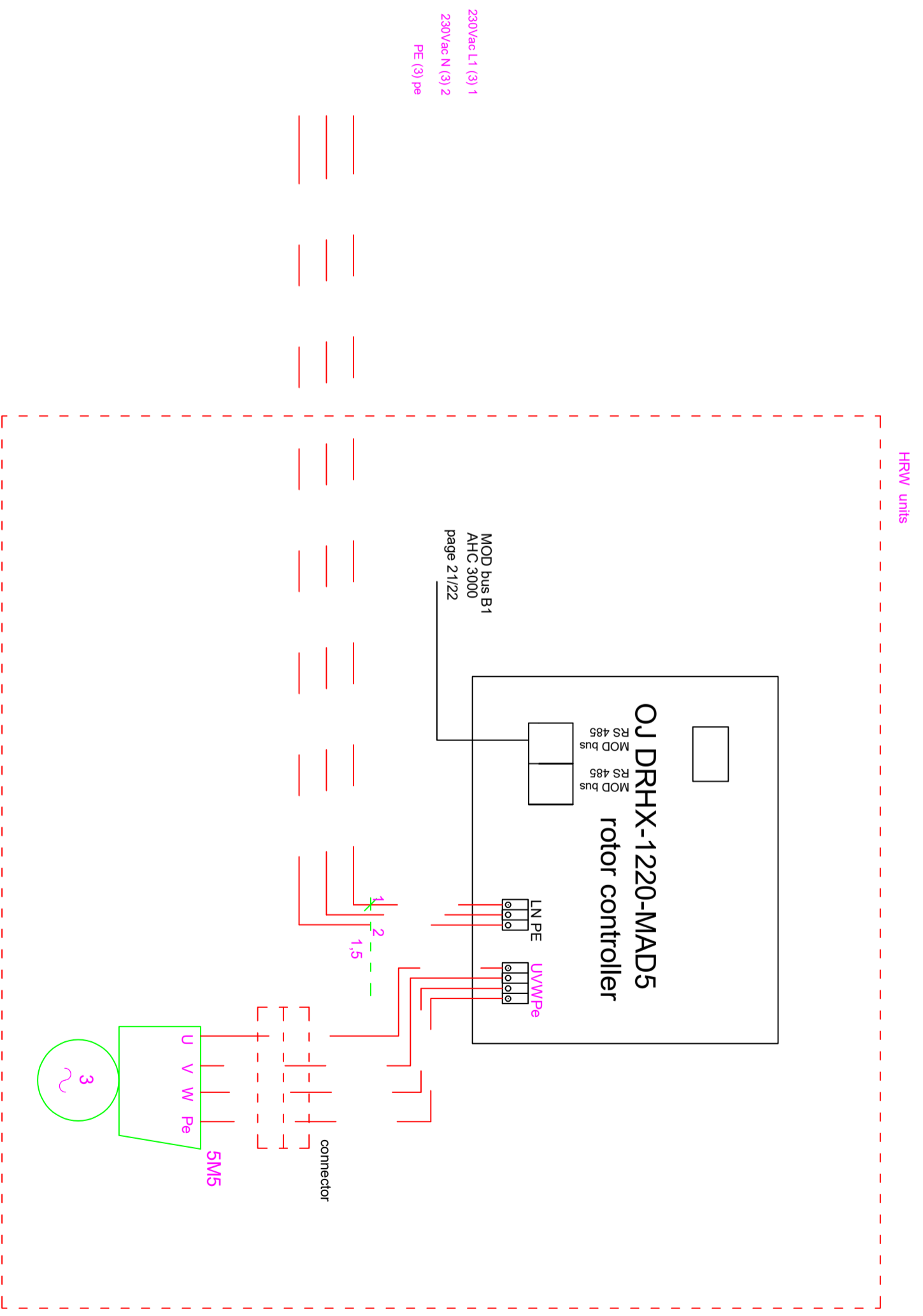

Get.	HMV	Order	AHC 3000	Blz:	24
Datum	4-9-2020	Type	9		
Datum	-	Rev.	-		
		status	-		
①					
②					
③					

1	2	3	4	5	6	7	8	9	10
					duct pressure	duct pressure			
					supply air	extract air			
					PTH 6202	PTH 6202			
					6	7			

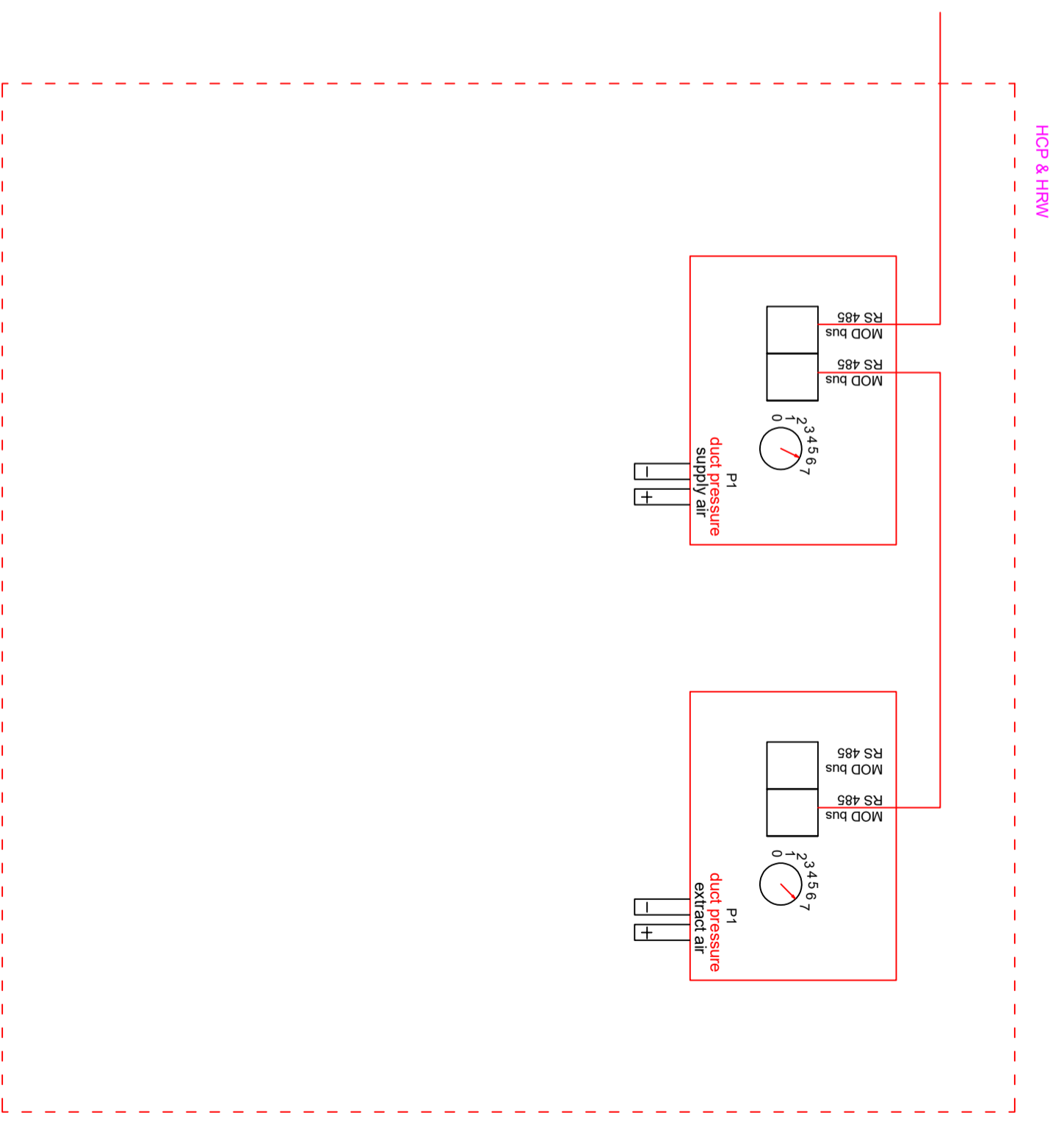

①	Get.	HMV
②	Datum	4-9-2020
③	Datum	-

Order Type	AHC 3000
Rev.	9
status	-

PTH 6202
pressure controlled supply and extract

Blz: **25**

AHC 3000 HMI 35T

OJ AIR HMI 20T

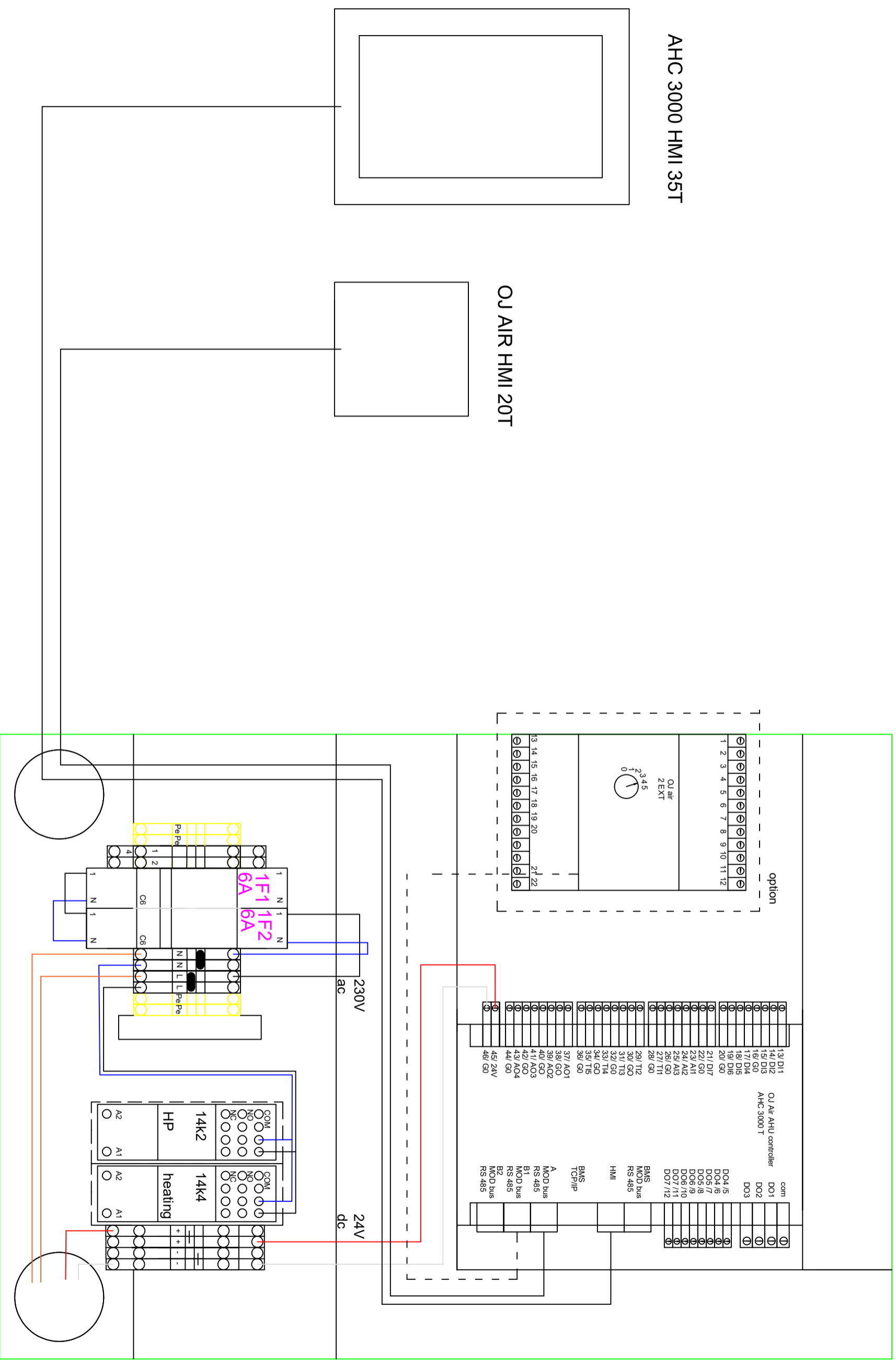

①	
②	
③	

Get.	HMV
Datum	4-9-2020
-	-
-	-

Order	AHC 3000
Type	9
Rev.	-
status	-

Page description	cabinet drawing 230V 1F, N, Pe
------------------	--------------------------------

Blz: 50

1

2

3

4

5

6

7

8

9

10

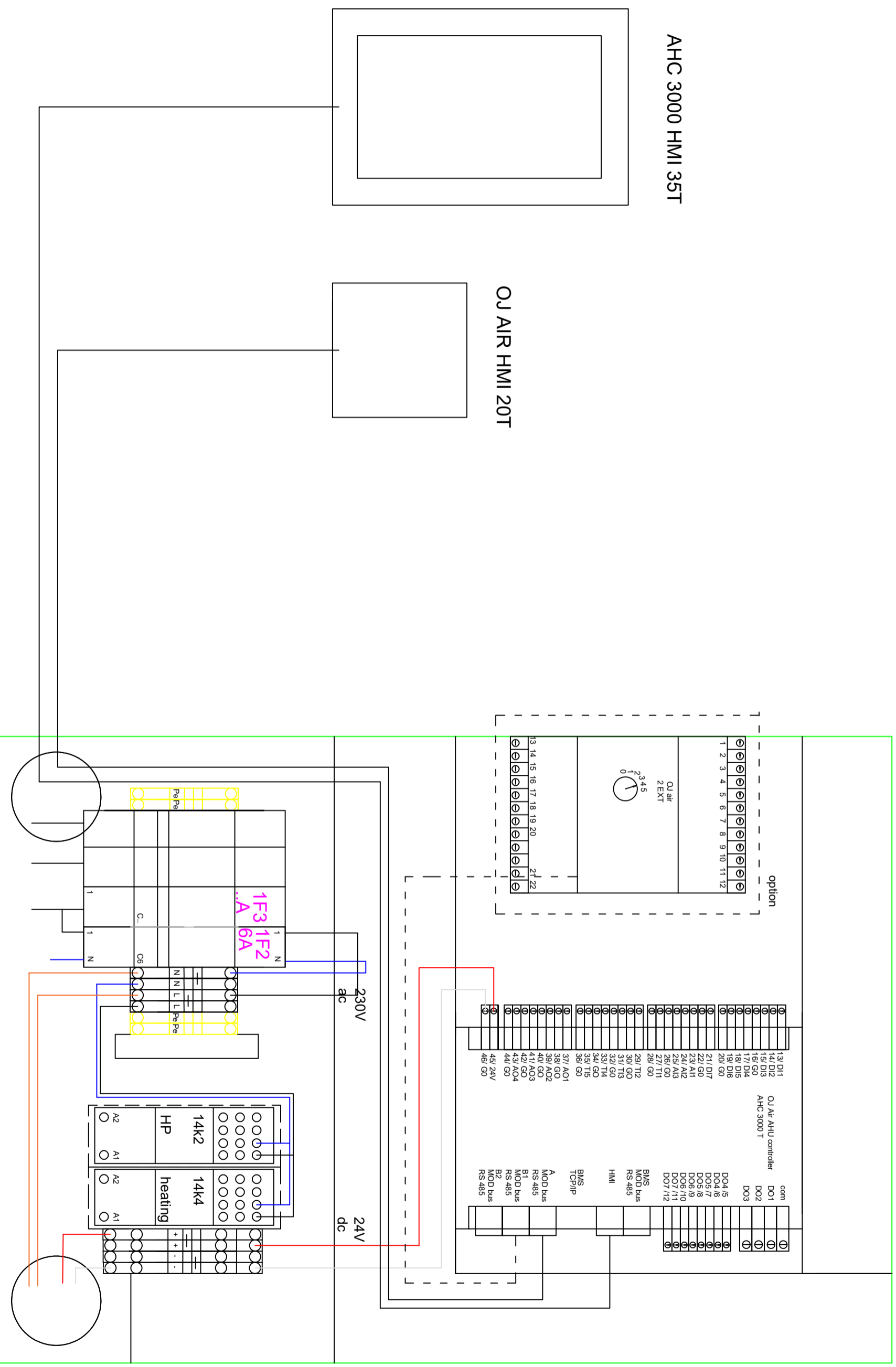

AHC 3000 HMI 35T

OJ AIR HMI 20T

Get.	HMV
Datum	4-9-2020
	-
	-

Order	AHC 3000
Type	9
Rev.	-
status	-

Page description	cabinet drawing 400V 3F, N, Pe
------------------	--------------------------------

Blz: 51

1

2

3

4

5

6

7

8

9

10

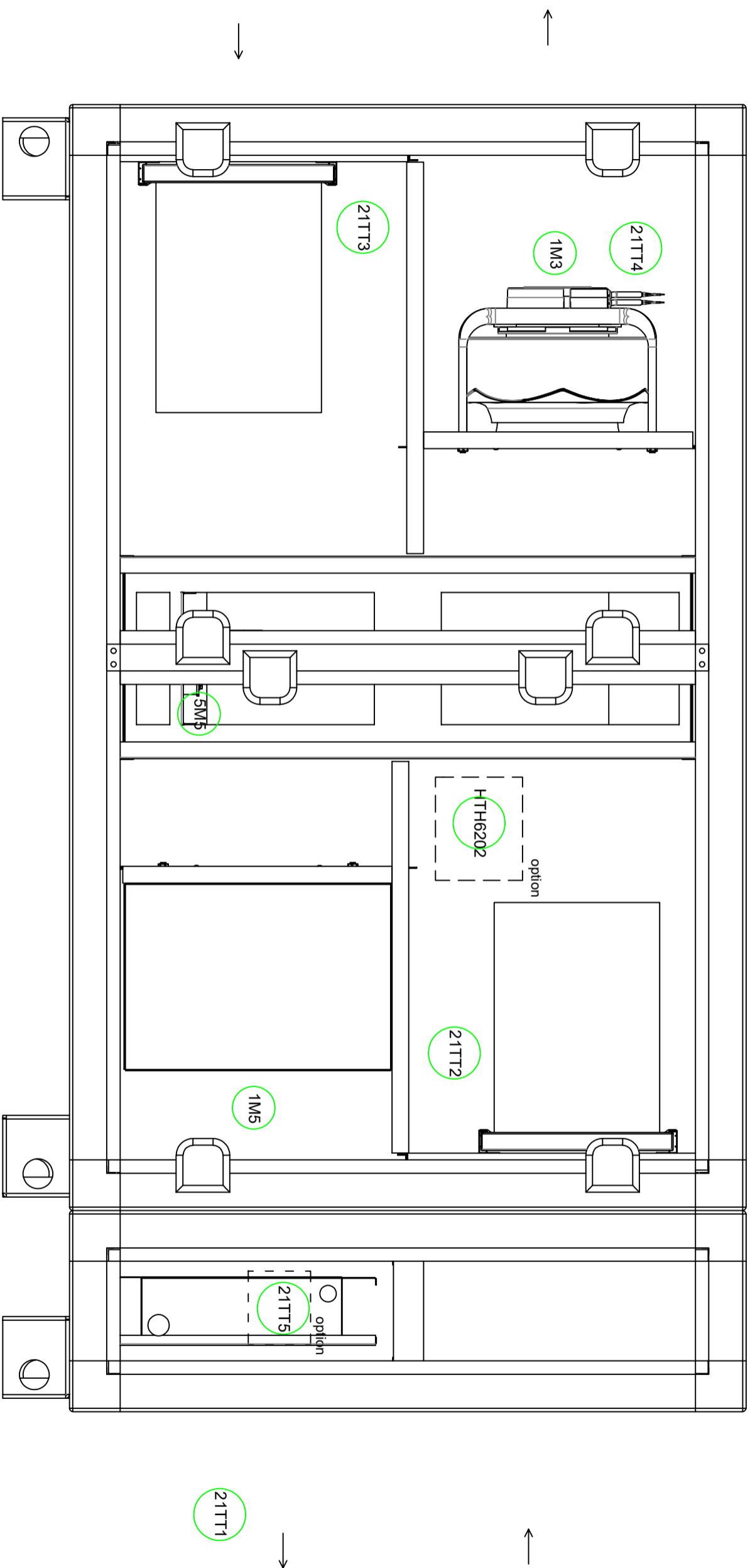

①	Get.	HMV
②	Datum	4-9-2020
③		

Order	AHC 3000
Type	9
Rev.	-
status	-

unit drawing

Blz: **60**

1

2

3

4

5

6

7

8

9

10

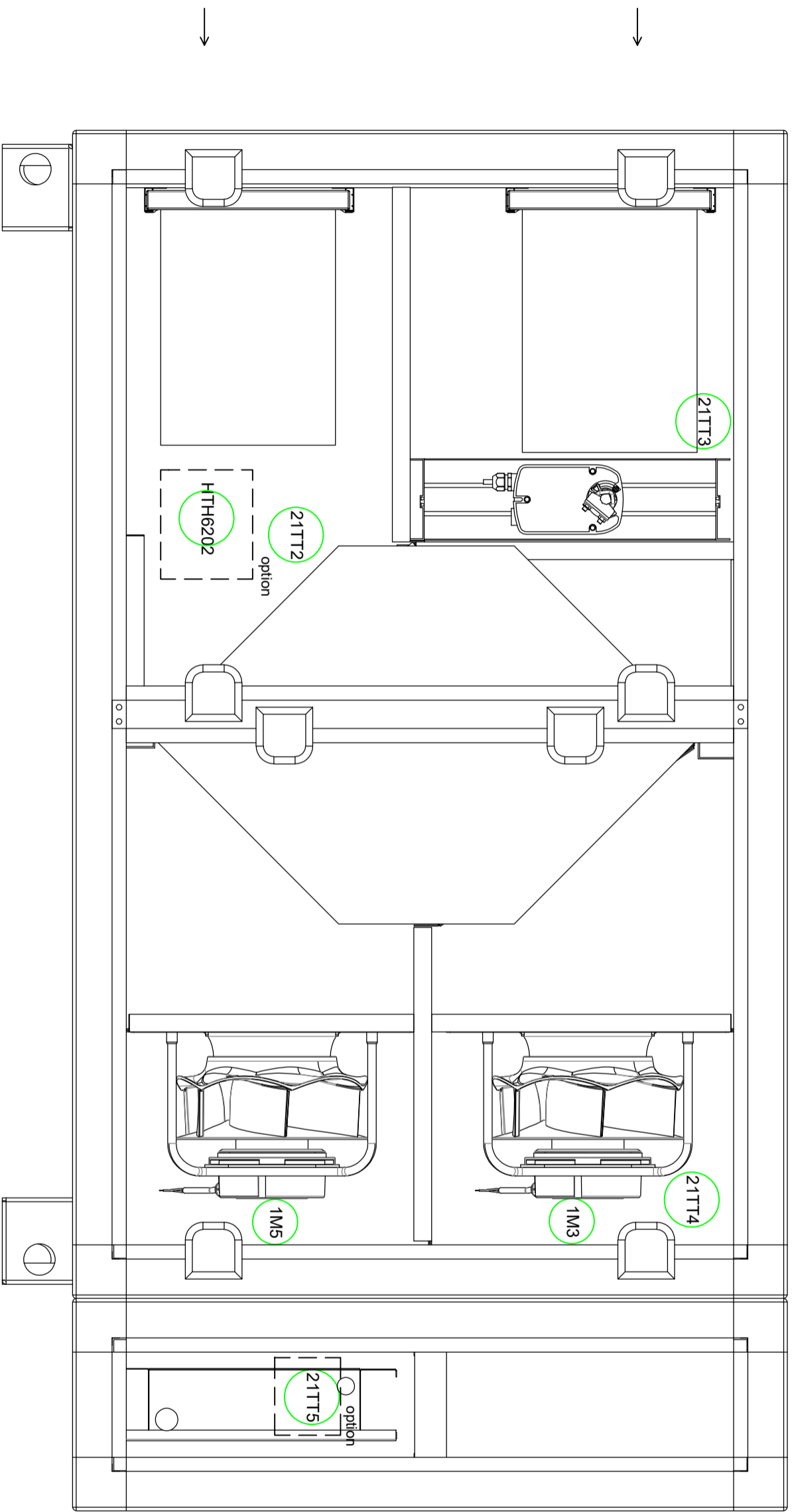

①	Get.	HMV
②	Datum	4-9-2020
③		-

Order	AHC 3000
Type	
Rev.	9
status	-

unit drawing

Blz: **61**